

Container specifications

REV6 / 2024.01.28 / JHHA-ROHO

20' Dry

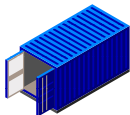

Length:	5.90 m
Width:	2.35 m
Height:	2.39 m
Door width:	2.34 m
Door height:	2.28 m
Max payload:	28.20 t
Capacity:	33 cbm
Max EUR pallets:	11

20' Open top

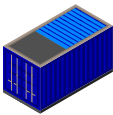

Length:	5.90 m
Width:	2.34 m
Height:	2.35 m
Door width:	2.29 m
Door height:	2.25 m
Max payload:	28.20 t
Roof opening:	5.68x2.25 m
Capacity:	32 cbm

20' Flat rack

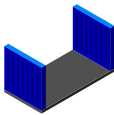

Length:	5.97 m
Length (inner):	5.70 m
Width:	2.36 m
Height:	2.24 m
Max payload:	27.15 t

20' Reefer



Length:	5.45 m
Width:	2.29 m
Height:	2.25 m
Door width:	2.29 m
Door height:	2.24 m
Max payload:	27.49 t
Capacity:	28 cbm
Max EUR pallets:	10

40' Dry

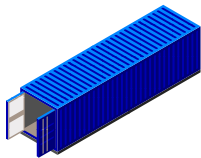

Length:	12.03 m
Width:	2.35 m
Height:	2.39 m
Door width:	2.34 m
Door height:	2.28 m
Max payload:	28.80 t
Capacity:	67 cbm
Max EUR pallets:	25

40' Open top

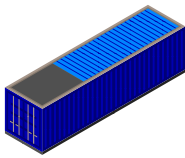

Length:	12.03 m
Width:	2.34 m
Height:	2.35 m
Door width:	2.29 m
Door height:	2.25 m
Max payload:	26.60 t
Roof opening:	11.81x2.22 m
Capacity:	64 cbm

40' Flat rack

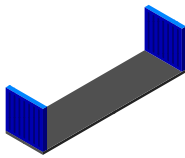

Length:	12.06 m
Length (inner):	11.66 m
Width:	2.37 m
Height:	2.28 m
Max payload:	39.30 t

40' Dry high-cube

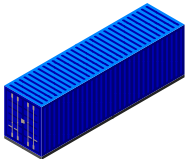

Length:	12.03 m
Width:	2.35 m
Height:	2.70 m
Door width:	2.34 m
Door height:	2.58 m
Max payload:	28.62 t
Capacity:	76 cbm
Max EUR pallets:	25

45' Dry high-cube

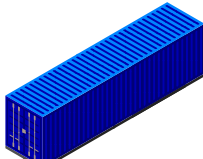

Length:	13.56 m
Width:	2.35 m
Height:	2.70 m
Door width:	2.34 m
Door height:	2.58 m
Max payload:	27.60 t
Capacity:	85 cbm
Max EUR pallets:	27

40' Reefer high-cube



Length:	11.58 m
Width:	2.29 m
Height:	2.50 m
Door width:	2.29 m
Door height:	2.50 m
Max payload:	28.35 t
Capacity:	67 cbm
Max EUR pallets:	23

Please note! Dimensions are a guideline only. For exact dimensions and container directions, please contact SSF Logistics. Containers for heavy cargo are available on request.